

Claude Moore Nonprofit Training Center

Sample Room Layouts



Please note: The following sample room layouts offer maximum occupancy for the Claude Moore Nonprofit Training Center. Guests may choose configurations with fewer tables/seating if desired.

#1: Large Square
Maximum: 49 people
(x's indicate each seat)

(Projector Screen)

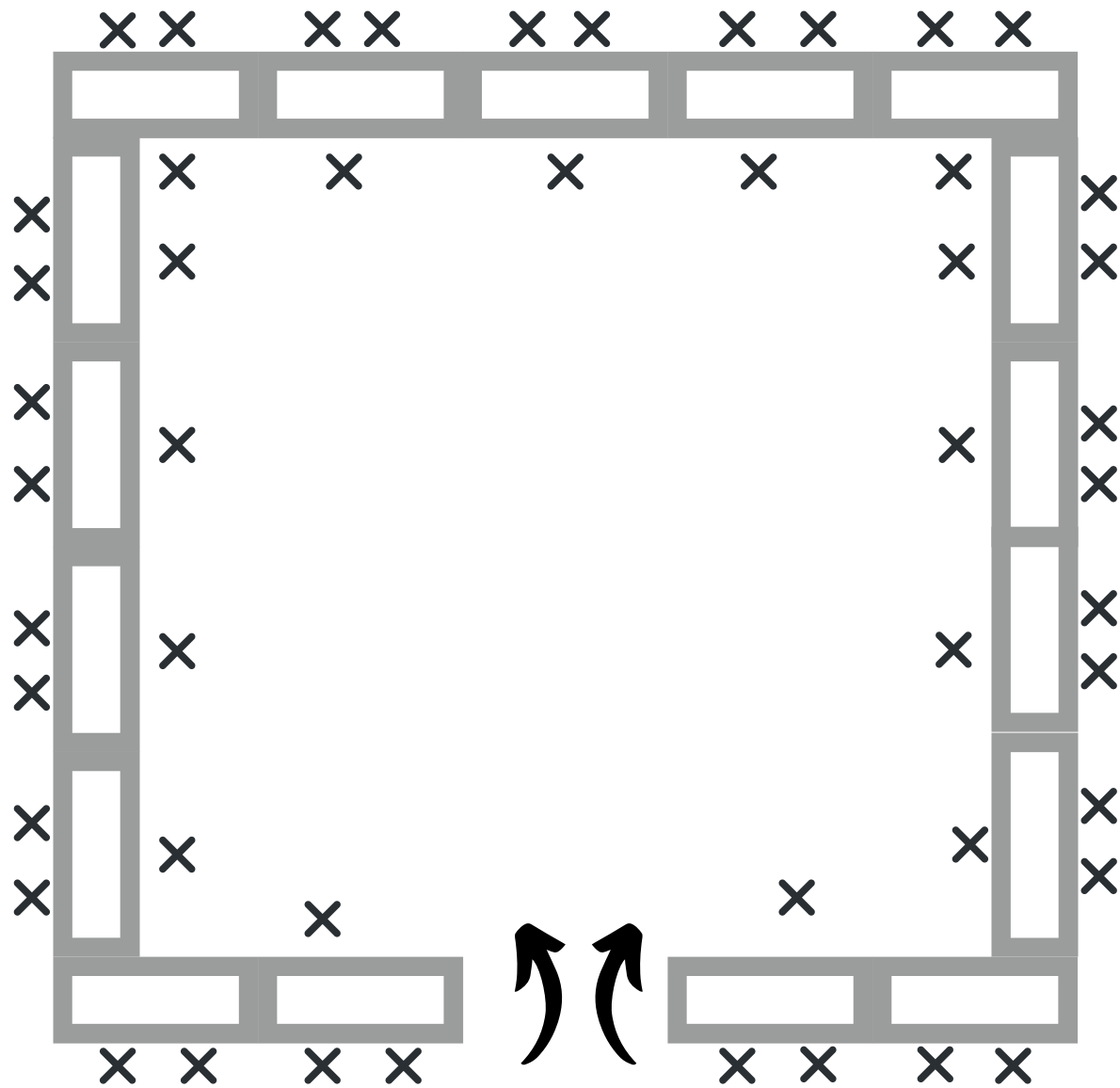

(Kitchen)

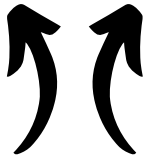

(Doors)

#2a: Square (with perimeter seating)
Maximum: 49 people
(x's indicate each seat)

(Projector Screen)

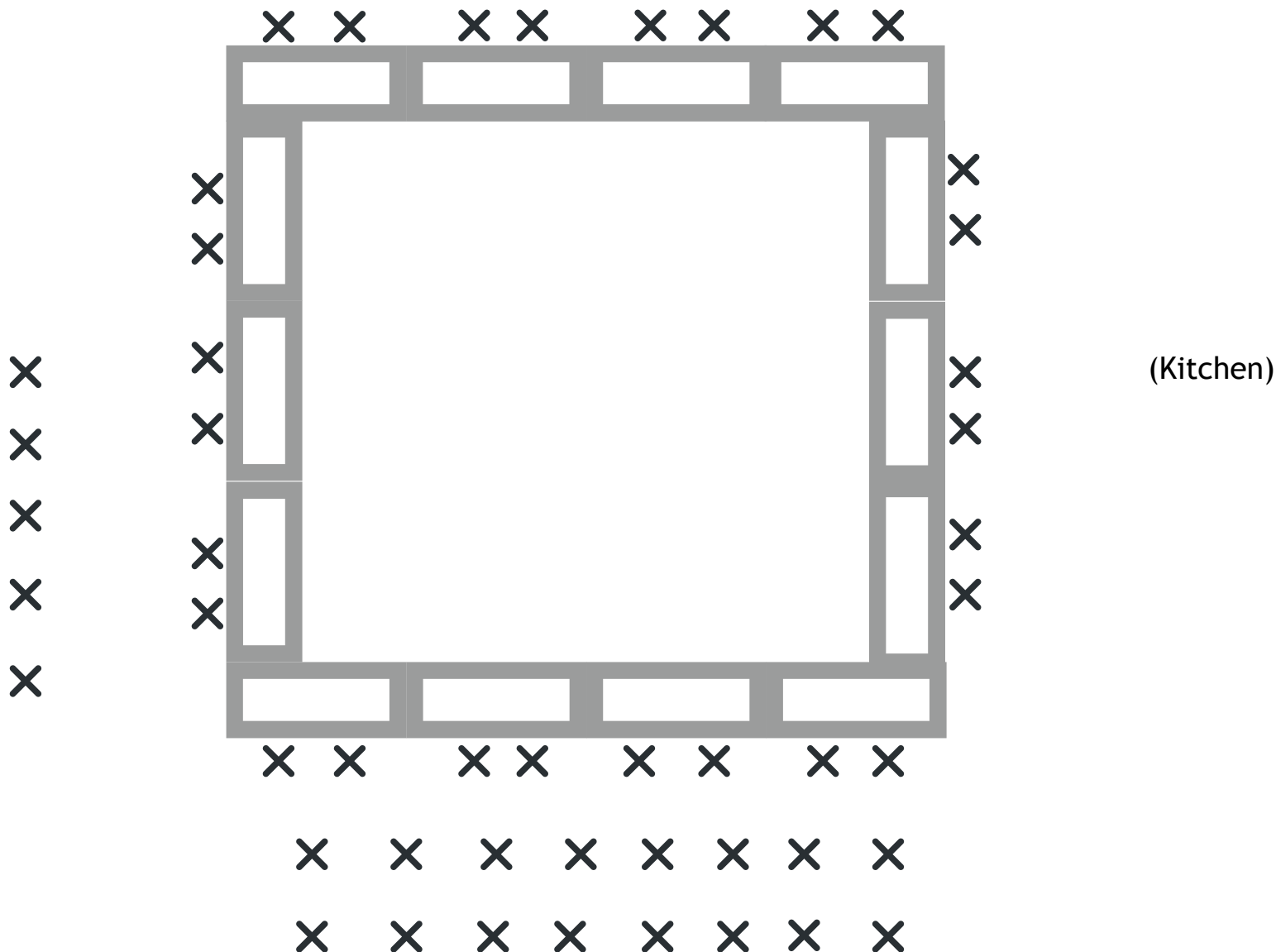

#2b: Square (with perimeter seating)
Maximum: 49 people
(x's indicate each seat)

(Projector Screen)

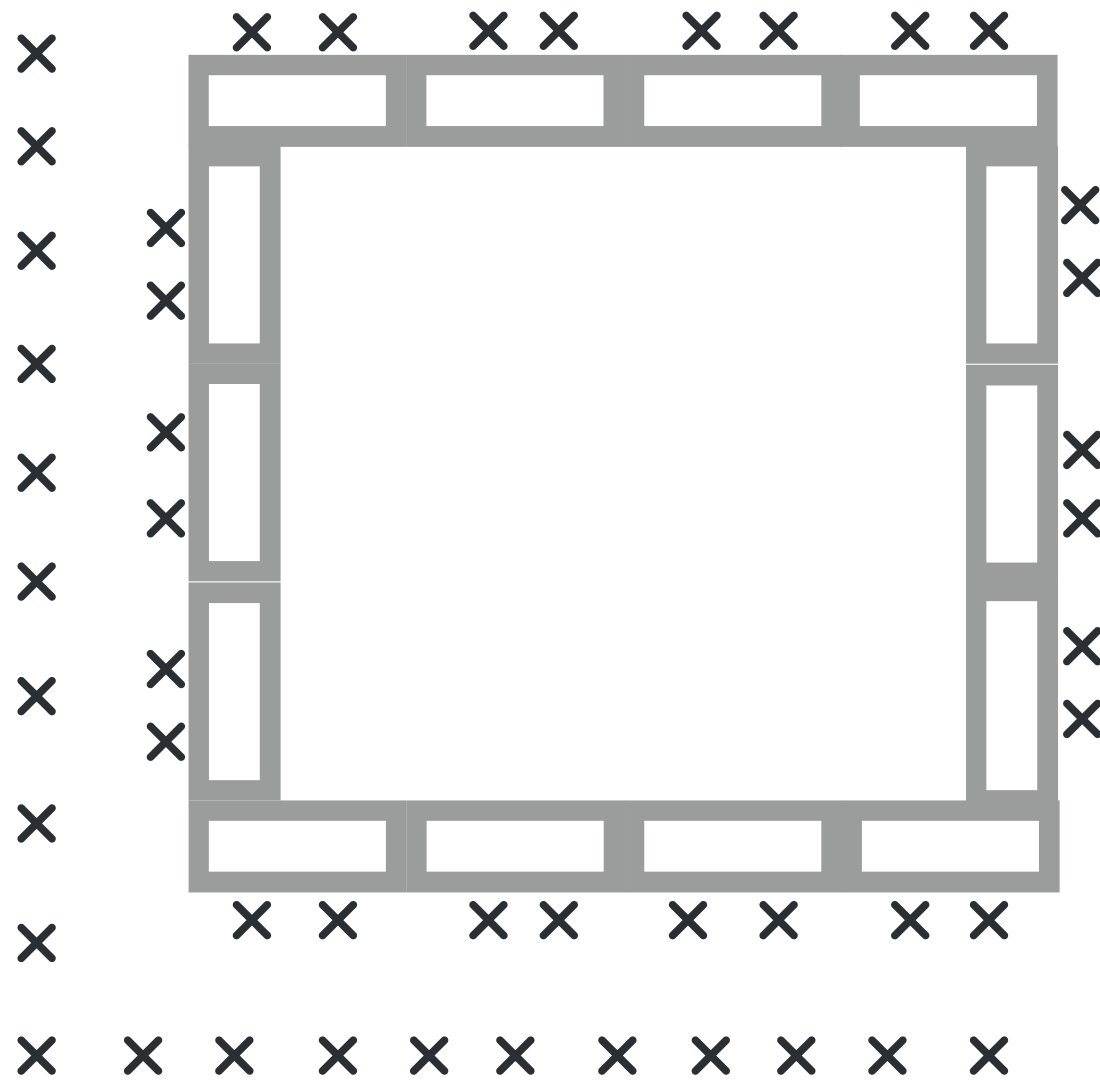

(Kitchen)

(Doors)

#3: U Formation

Maximum: 49 people

(x's indicate each seat)

(Projector Screen)

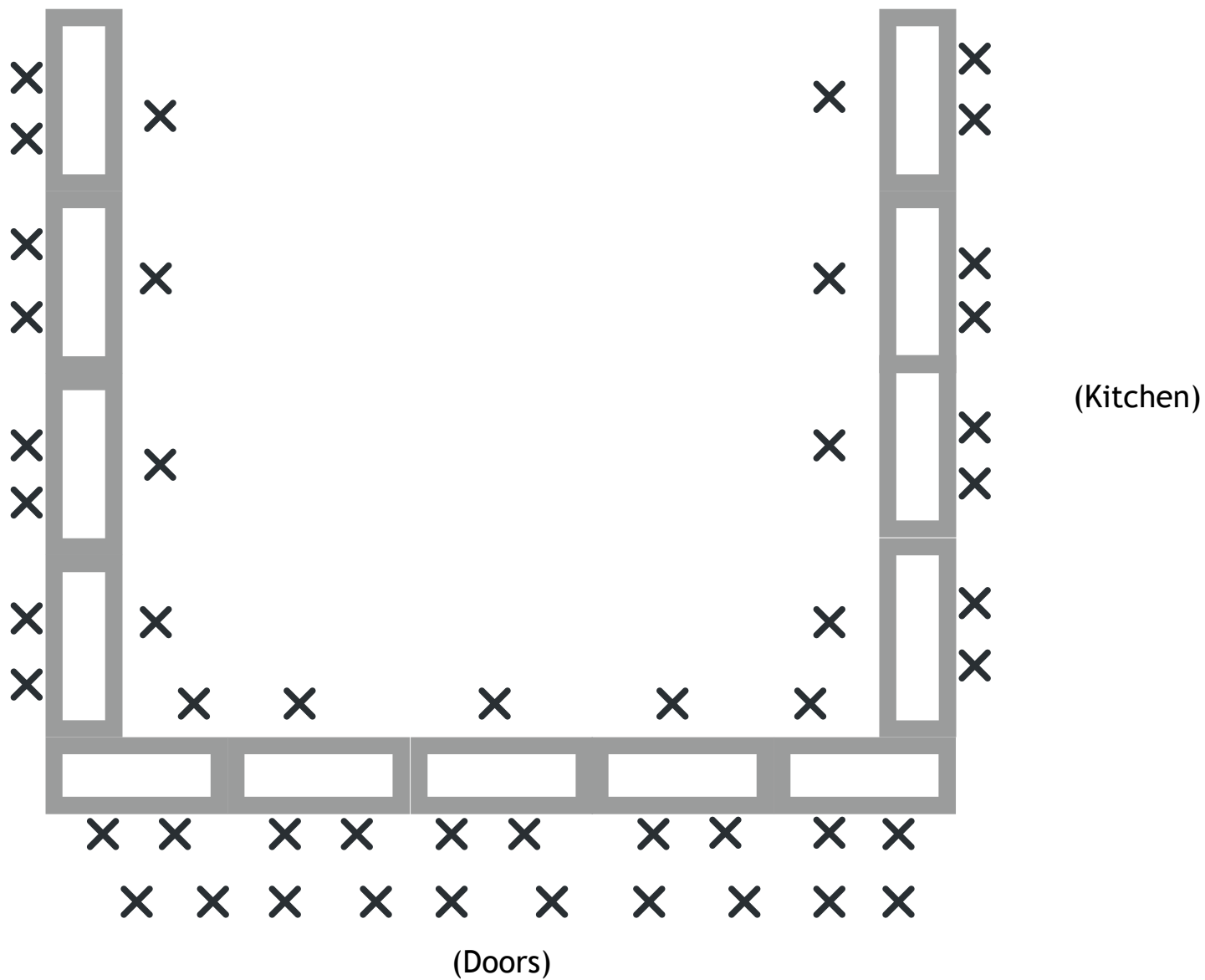

(Projector Screen)

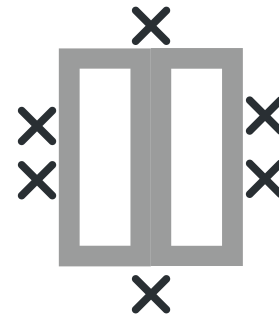
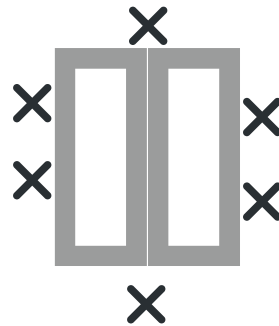
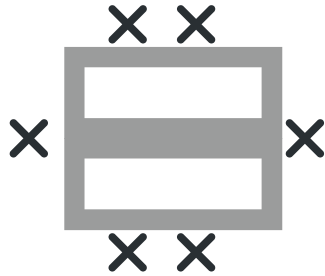
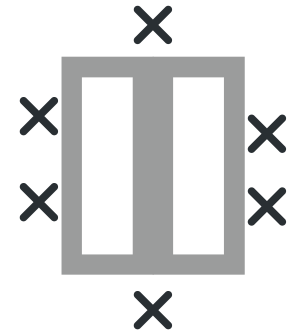
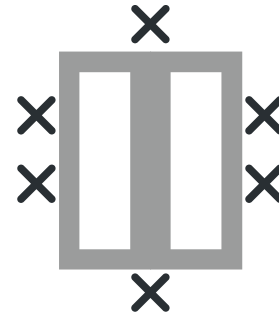
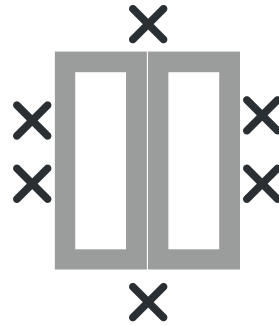
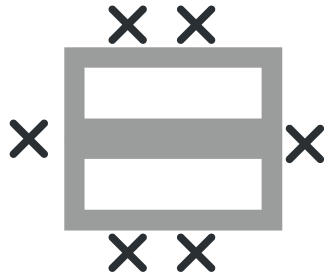

(Kitchen)

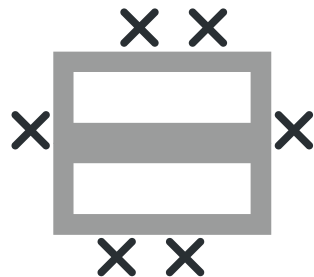

(Doors)

#4: Pod Formation
Maximum: 48 people
(x's indicate each seat)

#5: Classroom Style (with tables)

(Projector Screen)

Maximum: 49 people

(x's indicate each seat)

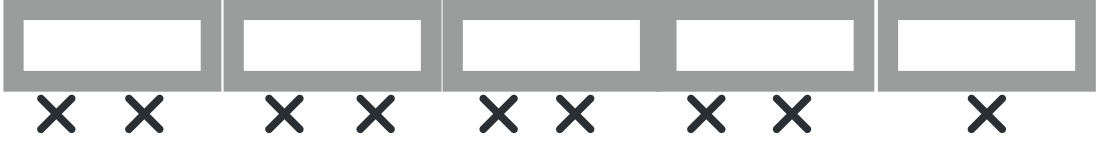
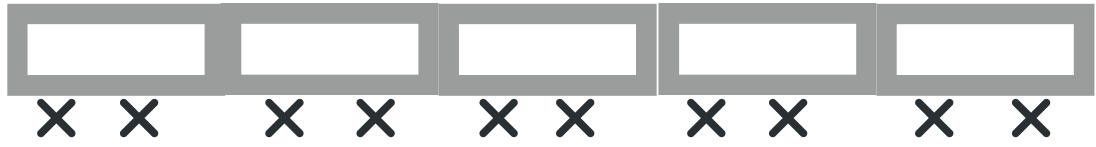

(Kitchen)

(Doors)

#6: Theater Style (no tables)

(Projector Screen)

Maximum: 49 people

(x's indicate each seat)



(Kitchen)

(Doors)